

TUBE END FACING MACHINE

The POWERMASTER Facing Machine is a powerful yet portable fixture designed to self-align and mount on tubes for fast tube end facing and chamfering in constrained spaces.

Features :

- Power and range combined in light and portable design.
- Drive : Electric, Hydraulic or Pneumatic
- Range of Tube end facing, external or internal bevelling and weld seam machining tool bits.
- Quick interchangeability of Pilot to suit range of inside diameters.
- Modular and Ergonomic design.

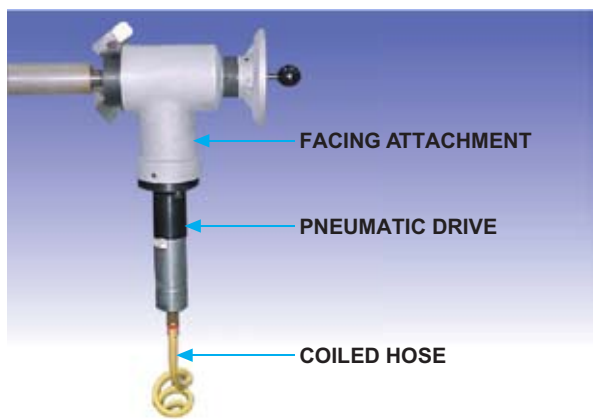

FACING ATTACHMENT

Locking Tube Range I.D. (mm)	28-82
Weight (kg)	6.8
Model	FM-3500

DRIVE

Motor	Pneumatic	Electric	Hydraulic
Torque (Nm)	84	138	140
Speed (rpm)	135 @ 500 lpm	70	480
Weight (kg)	1.8	2.8	5.6
Model	MD-P	FMD-E	FMD-H

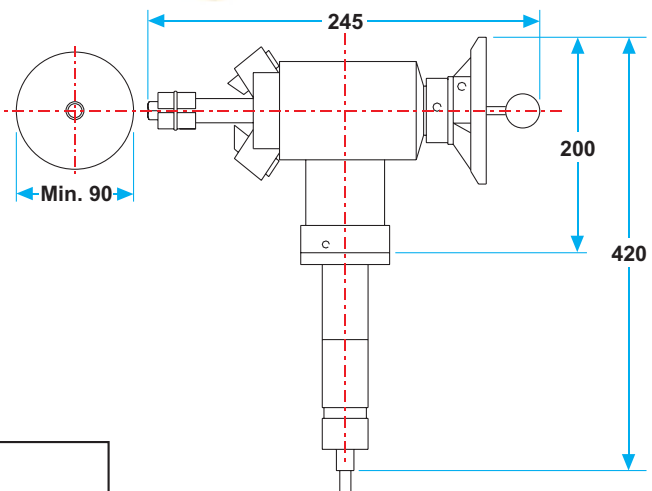

Note : All Dimension in MM

CUTTING BITS

EXTERNAL BEVELLING

INSIDE BEVELLING

STRAIGHT BEVELLING

WELDED SEAM MACHINING

CUTTING BITS

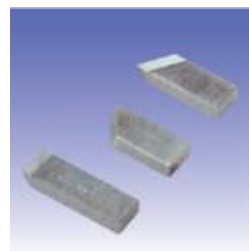

PILOT JAWS

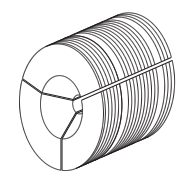

PILOT JAWS ARE AS PER TUBE INNER DIAMETER.

OPTIONAL ELECTRIC OR HYDRAULIC DRIVE

